

Sunshade MODEL : A090 Series

WISE®

Service intended

Sunshade provides protection for instrument preventing instrument calibration drift due to temperature changes caused by solar radiation. sunshade mounts to a typical 2 inch stanchion pipe and can be removed easily for full instrument access.

Application

Simple shielding of enclosures, instruments and fittings providing protection against

- Sun light
- Dirt accumulation
- Exposure to atmospheric conditions

Features

- Reduces the surface temperature of instruments or enclosure
- Minimizes instrument drift
- Operating Temperature : -15°C~100°C
- UV coating



ACCESSORIES FOR PRESSURE GAUGE

Ordering information

BASE MODEL - A090 (1st thru 4th characters)

5th ~9th Character		10th Character		11th Character		12th Character	
CODE	Sunshade W×D×H(mm)	CODE	Sunshade MAT'L	CODE	Gauge Bracket	CODE	Gauge Bracket MAT'L
SS230	230×370×125	1	GRP	1	Ø90×120ℓ	1	Steel with Galvanized
SS410	410×350×170	2	FRP	2	Ø93×120ℓ	2	316SS
SS000	Other	3	Other	3	Ø103×120ℓ	3	Other
				4	Ø130×120ℓ		
				5	Other		

13th Character		14th Character		15th Character	
CODE	Mounting Position	CODE	Pipe Stanchion	CODE	Mounting Bracket
1	Back	1	PS	1	PB
2	Top	0	None	2	UB
				0	None

Dimensions (Unit: mm)

SS230

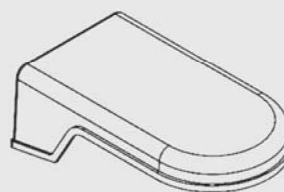
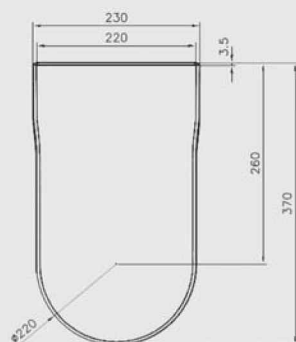
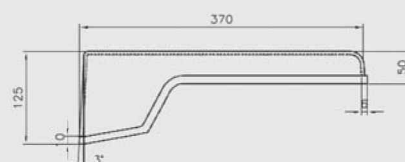
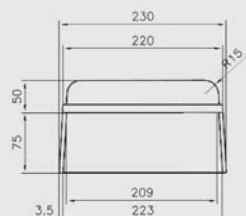

SS410

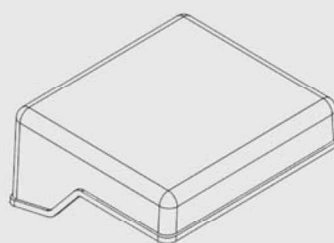
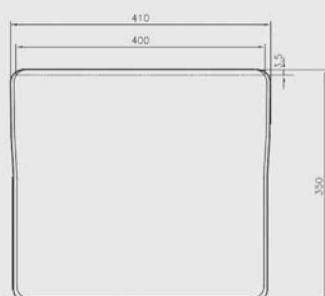
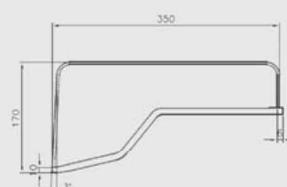
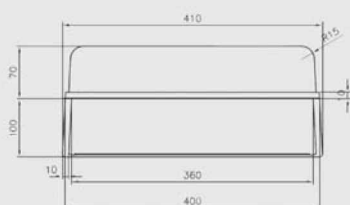

Mounting accessories

GAUGE BRACKET (11th character) Back Mounting / Ø103 or Ø119×120ℓ

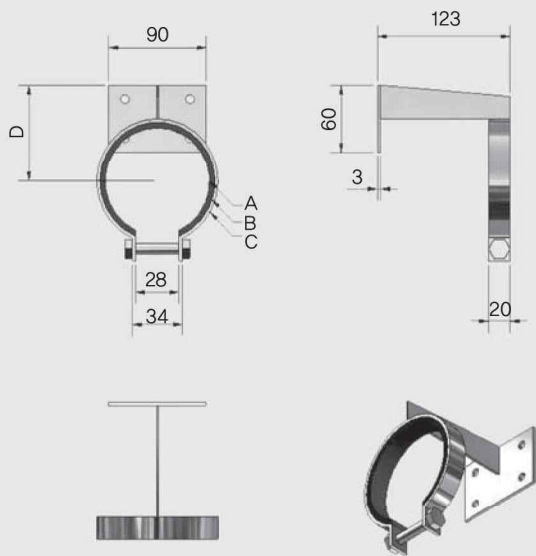

Unit: mm

No.	A	B	C	D
1	Ø90	Ø100	Ø106	83
2	Ø93	Ø103	Ø109	84.5
3	Ø103	Ø113	Ø119	88
4	Ø130	Ø140	Ø146	103

A soft rubber cushion (5mm) attached to the internal side of gauge bracket.

Top Mounting / Ø103 or Ø119×120ℓ

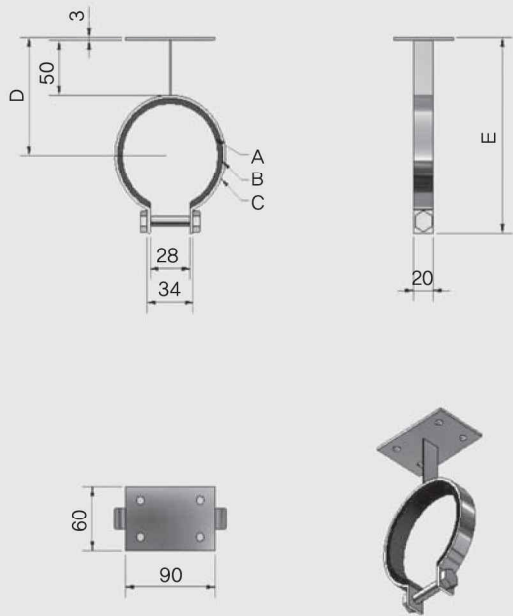

Unit: mm

No.	A	B	C	D
1	Ø90	Ø100	Ø106	83
2	Ø93	Ø103	Ø109	84.5
3	Ø103	Ø113	Ø119	88
4	Ø130	Ø140	Ø146	103

A soft rubber cushion (5mm) attached to the internal side of gauge bracket.

Mounting accessories

2 inch PIPE STANCHION (14th character)

Code 1: PS

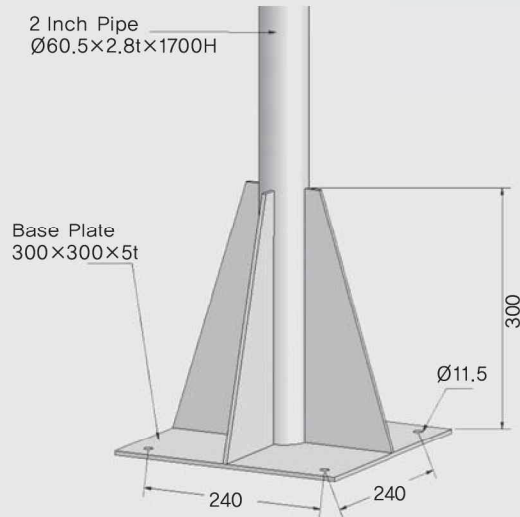

MOUNTING BRACKET (15th character)

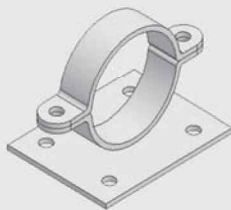

Code 1: 2 inch Pipe Band for Mounting(PB)

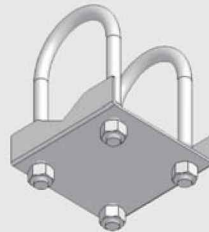

Code 2: 2 inch U-bolt Type Shackle for Mounting (UB)

Mounting example for shade SS230

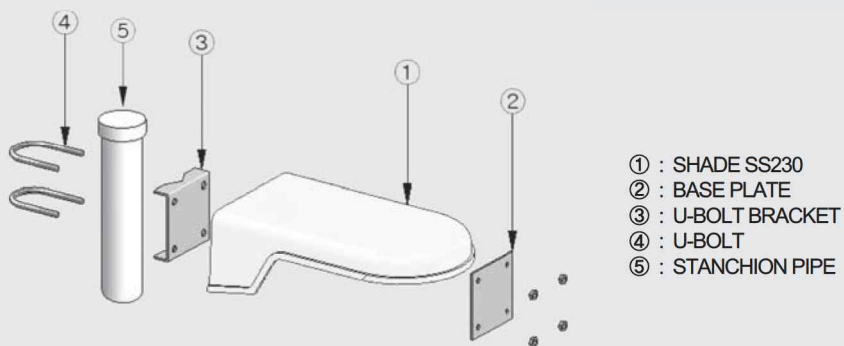

Mounting example for shade SS230

BACK MOUNTING (Total Weight \approx 1.5kg)

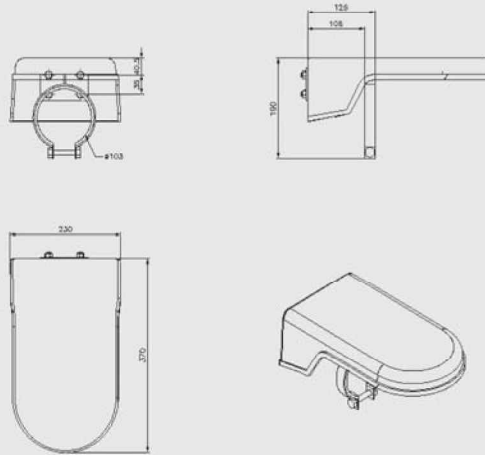

TOP MOUNTING (Total Weight \approx 1.55kg)

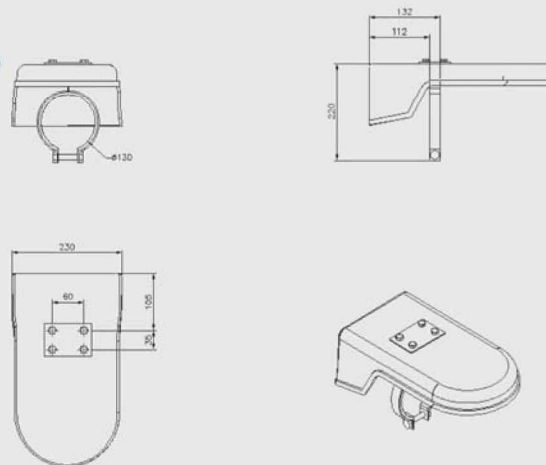

2 inch U-BOLT MOUNTING (Total Weight \approx 1.57kg)

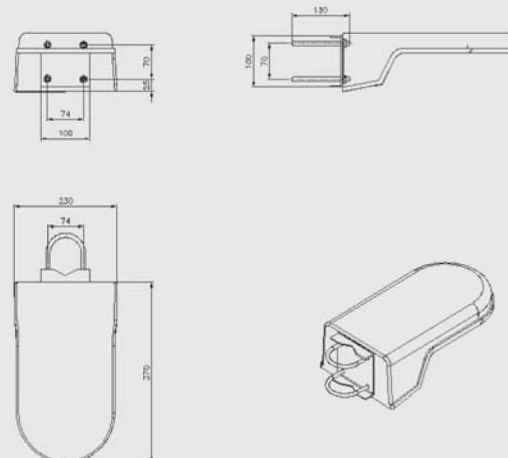

Mounting example for shade SS230

PIPE-BAND MOUNTING (Total Weight \approx 1.5kg)

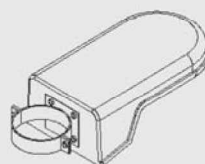
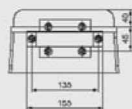

L-TYPE FIXED MOUNTING (Total Weight \approx 1.5kg)

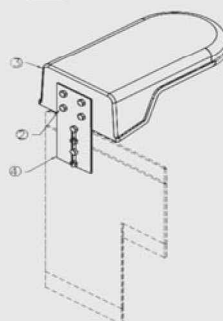
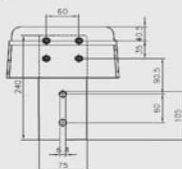

SPECIAL MOUNTING (Total Weight \approx 2.2kg)

